



**TAHOMA**  
HIGH SCHOOL



# ARCHITECTURAL CONCRETE MASONRY

[ Serving Washington & Oregon ]

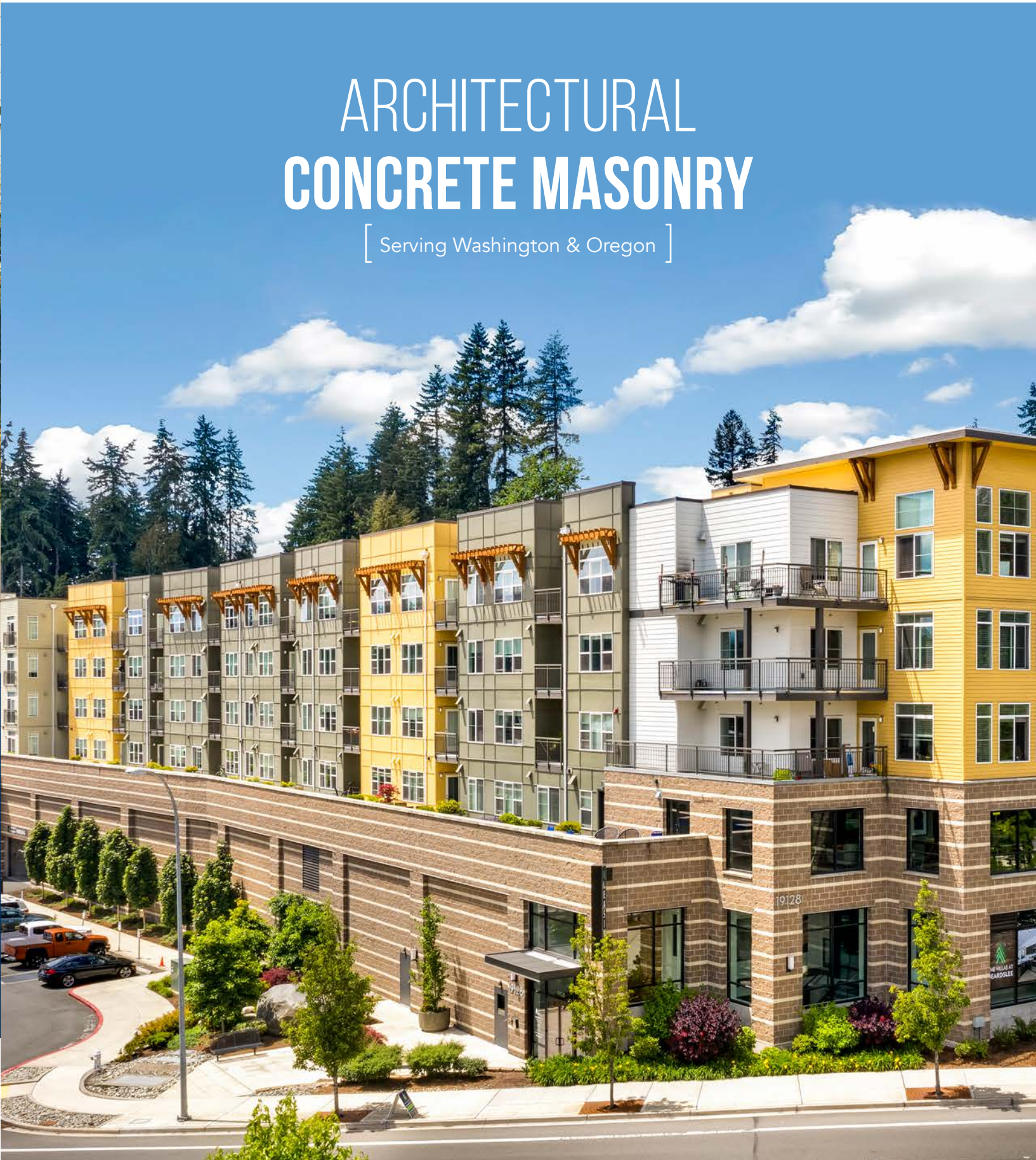

Front Cover Gateway Apartmentst in Mesa Buff CMU and back cover Tahoma High School



3299 International Place  
Dupont, WA 98327  
253-964-5000

1945 South 1st St.  
Redmond, OR 97756  
541-548-5910

ALBERTA • BRITISH COLUMBIA • CALIFORNIA • COLORADO • IDAHO • NEVADA • OREGON • WASHINGTON

©2020 Basalite® Concrete Products, LLC. All trademarks ® are registered trademarks. 3/20/2022 WA-KQ 500

Visit [basalite.com](http://basalite.com), find or follow us on







Caldera High, Ground Face 8" High in Glacier White



Office Suites, Ground Face 8" High in Pewter

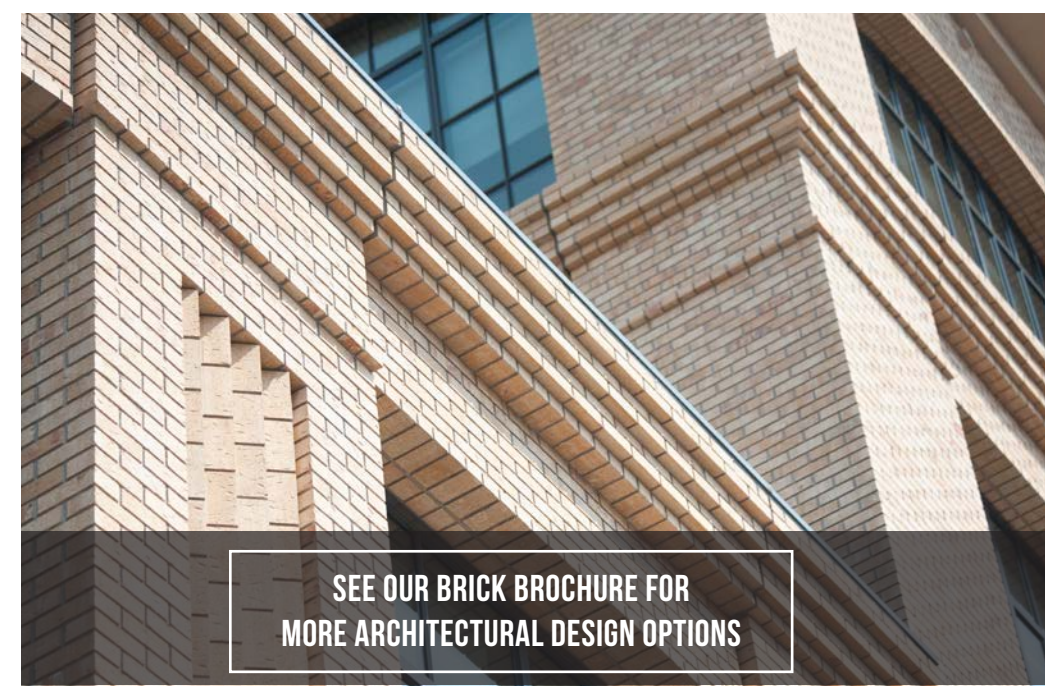

SEE OUR BRICK BROCHURE FOR MORE ARCHITECTURAL DESIGN OPTIONS



Northstar Elementary, Pewter Ground Face & Ebony Splitface, 8" High



Harvard Elem., Ground Face 8" High in Custom Blend



Harrison Medical Center, Ground & Precision Face 8" and 4" High in Natural



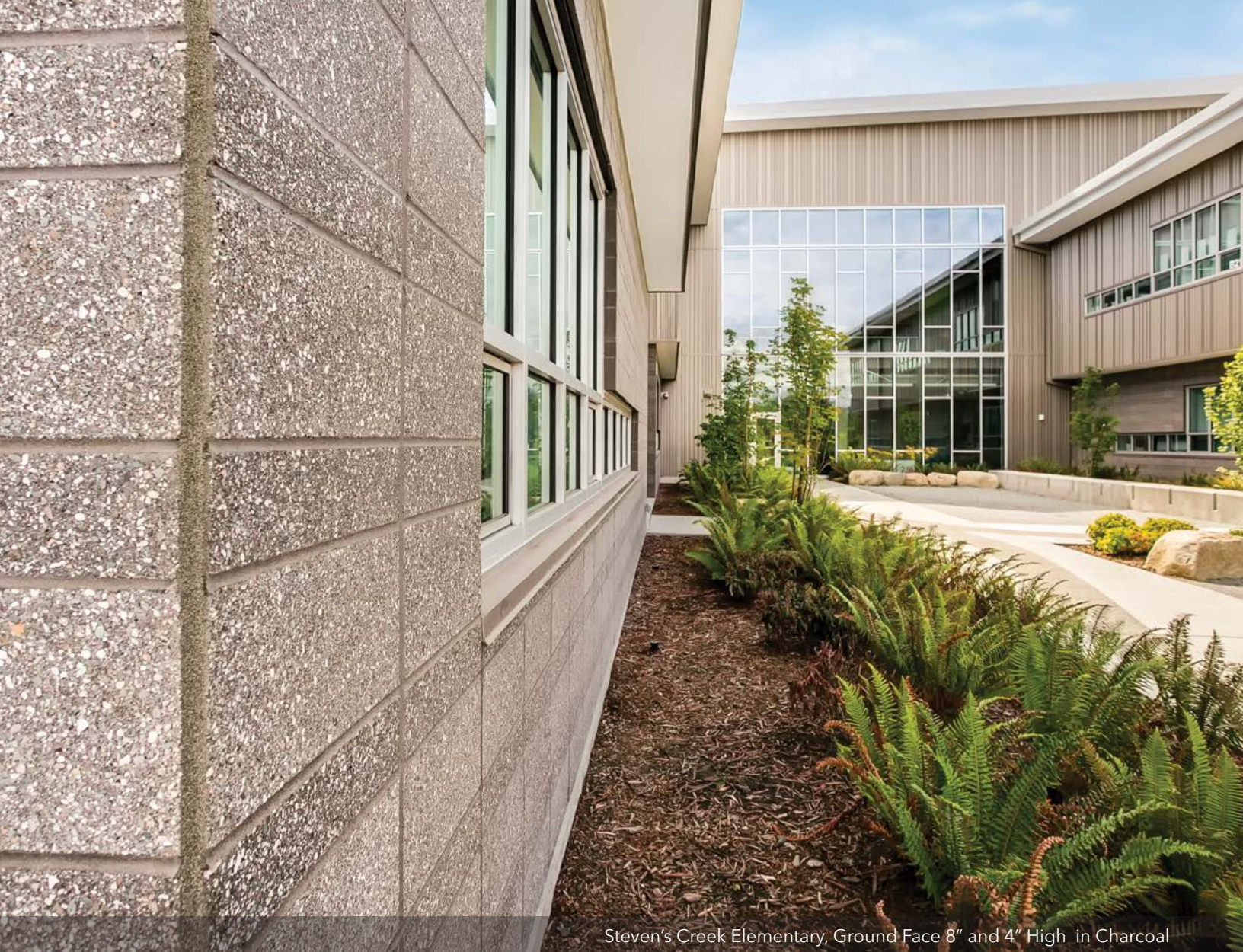

Steven's Creek Elementary, Ground Face 8" and 4" High in Charcoal

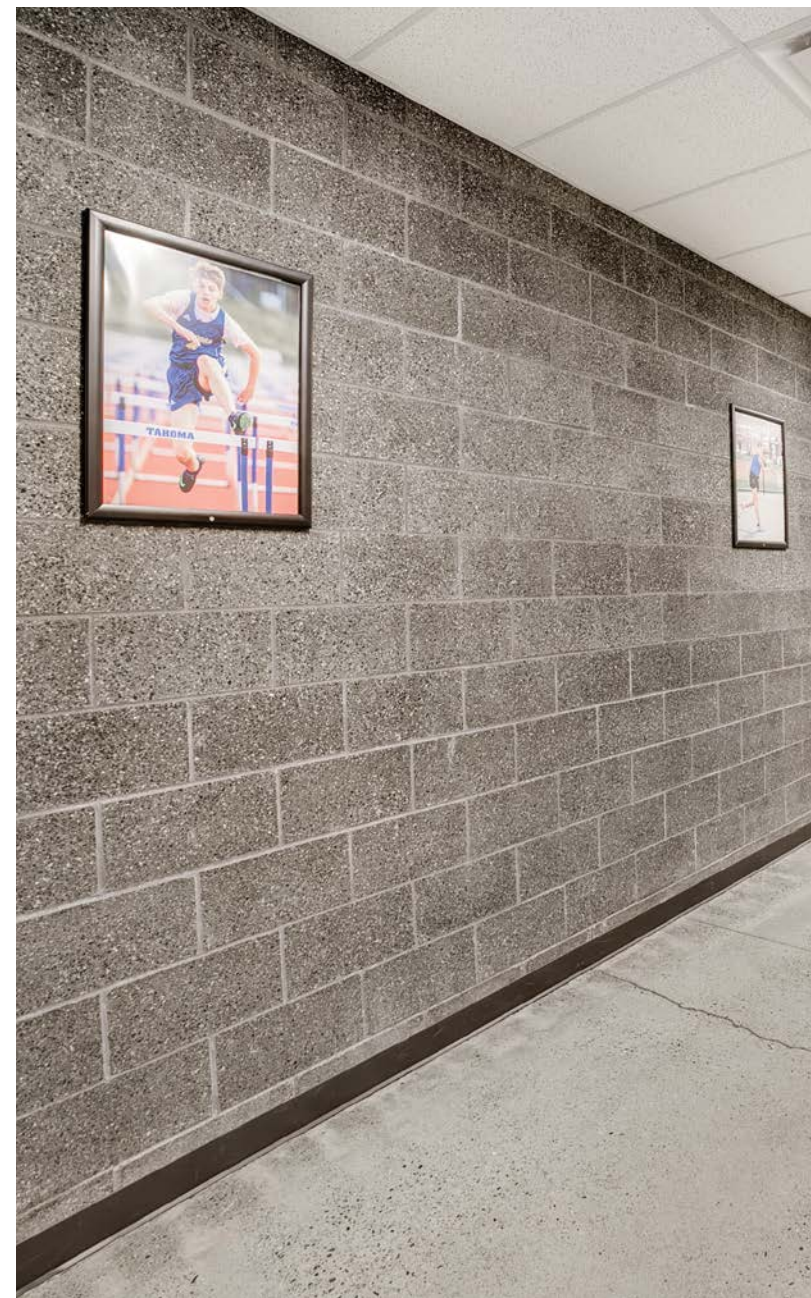
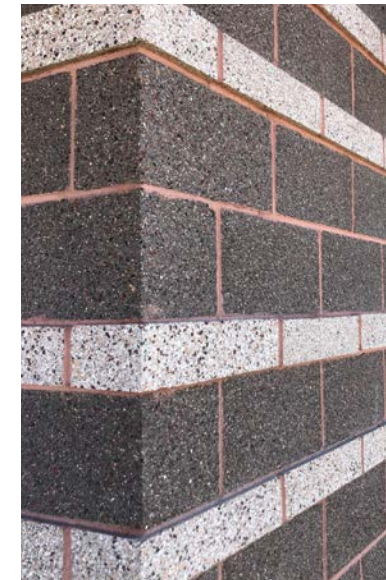

# TABLE OF CONTENTS

## CMU

ADVANTAGES | 5

## SHAPES

ABRI | 7

4 INCH CMU | 8

6 INCH CMU | 8

8 INCH CMU | 9

10 INCH CMU | 10

12 INCH CMU | 10

## SPECIALTY

SILLS, CAPS & LINTELS | 11

INSULATION INSERTS | 12

SPEC-BRIK® | 13

## COLORS & TEXTURES

GROUND FACE | 15

SPLIT FACE | 16

PRECISION | 17

MORTAR | 18

# SPECIFY WITH CONFIDENCE

All our products are manufactured to meet or exceed CMU manufacturing standards for strength and durability. Our commitment to providing high-quality products and excellent customer service will ensure that your project will be customized to your needs.

Meet with one of Basalite's CMU experts to help with your project, from the initial planning stages through final engineering and approval.



### REQUEST SAMPLES

Need product samples? Email [dupontsales@basalite.com](mailto:dupontsales@basalite.com) or call 253-964-5000 to get your samples.



### TECHNICAL DOCUMENTS

Looking for data sheets, specifications, Environmental Product Declarations and technical notes? Visit [basalite-cmu.com](http://basalite-cmu.com)



### LOCALLY MADE

Every Basalite CMU is proudly manufactured in our Dupont facility, allowing us to deliver precision-made products to you, wherever and whenever you need them.



# CONCRETE MASONRY

## CMU HAS MORE ADVANTAGES THAN YOU CAN IMAGINE.

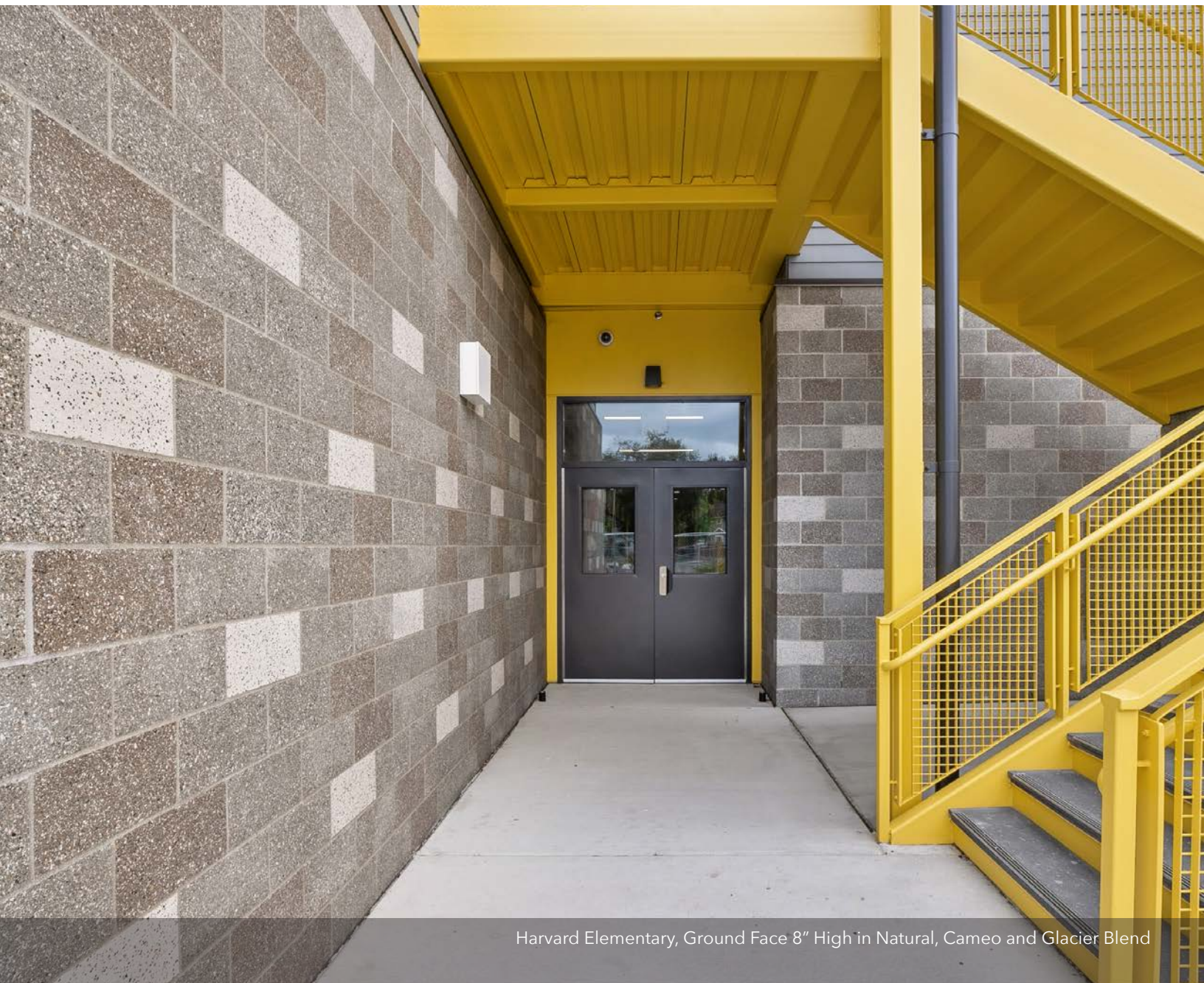

Harvard Elementary, Ground Face 8" High in Natural, Cameo and Glacier Blend

### MOISTURE PROTECTION & EFFLORESCENCE CONTROL

When it comes to moisture protection, you can specify an Integral Water Repellent (IWR) in both Basalite® block and mortar. During the manufacturing process we use Integral Water Repellent add mixtures that are mixed throughout the concrete. The IWR increases resistance to wind-driven rain, moisture penetration, and reduces efflorescence.

### COLORS & TEXTURES

Turn ordinary into a visual masterpiece by blending Basalite® colors, surface textures, sizes and shapes. We offer a large selection of Standard, Premium and special order colors that are available in Split Face, Ground Face and Precision textures. Speak with your local product expert to get samples.

### SHAPES & SIZES

Create unique and memorable design details with Basalite®'s variety of concrete masonry sizes and shapes. From a large 24" long block to specialty sills and caps. See pages 7-11 to see all available CMU sizes and shapes.

### RESILIENCY

Buildings and structures with resilient design and materials can recover quicker following disasters, reduce green house emissions and improve the impacts of a building on the health and performance of occupants. Concrete masonry construction has inherent strength, durability, longevity, fire resistance, seismic and blast resistance all of which contribute to the resiliency of the built environment and can contribute to LEED credits.

### THERMAL PERFORMANCE

Due to the thermal mass of concrete masonry construction, some energy codes and standards require less insulation in CMU buildings than in equivalent light-frame structures. Although the thermal mass and inherent R-value/U-factor of CMU may be enough to meet energy code requirements (particularly in warmer climates), CMU buildings may need additional insulation. For such conditions, Basalite® offers Korfil insulation inserts. See page 12 for more information.



# SHAPES | ABRI

For texture availability please refer to the letter designation under each shape.

## BRING A NEW DIMENSION

ABRI units are available in five shapes and are suitable for vertical or horizontal placement. This opens up a world of possibilities to create unique and fresh wall designs with unexpected profiles and combinations.

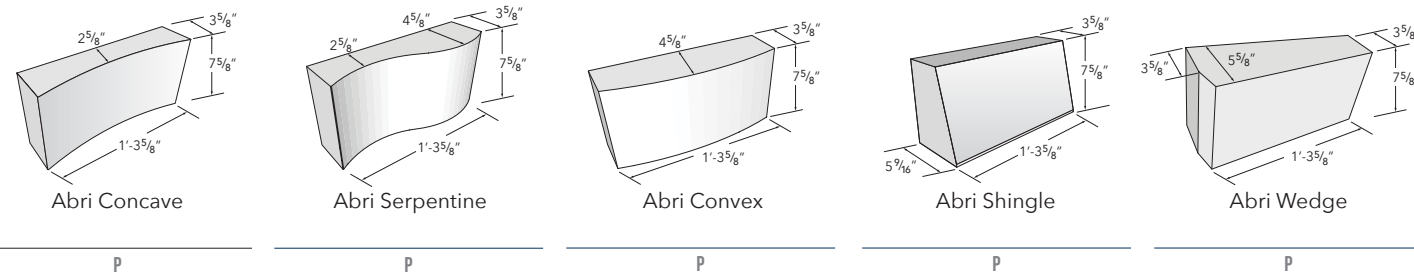
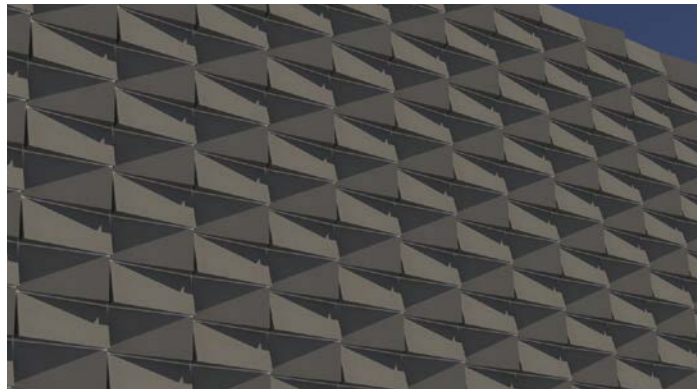
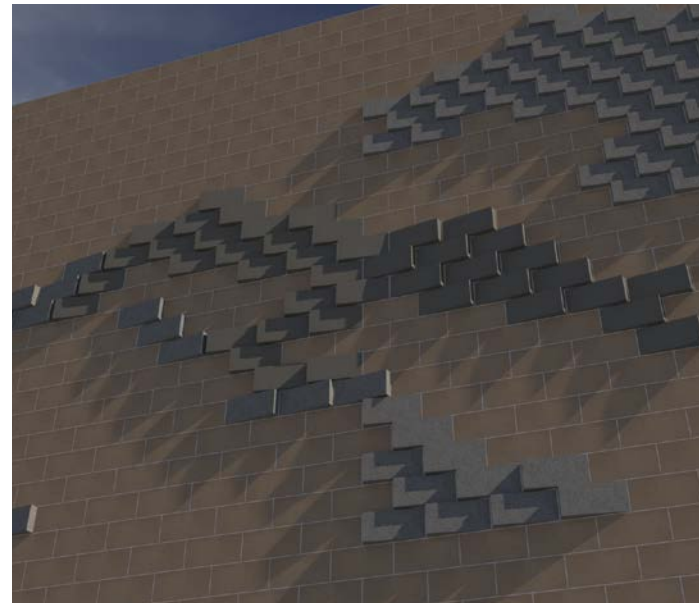

P | Precision

# SHAPES | 4 INCH CMU

For texture availability please refer to the letter designation under each shape.

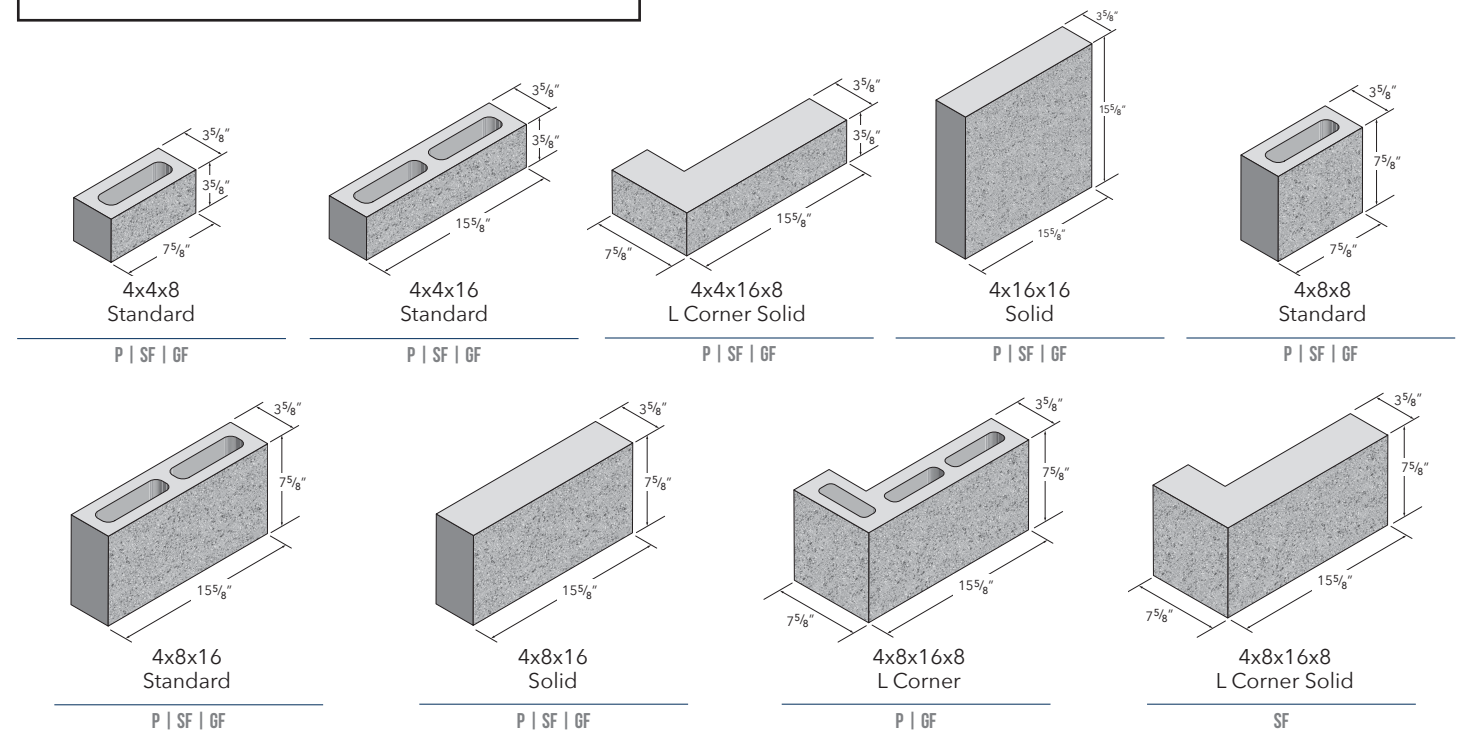

# SHAPES | 6 INCH CMU

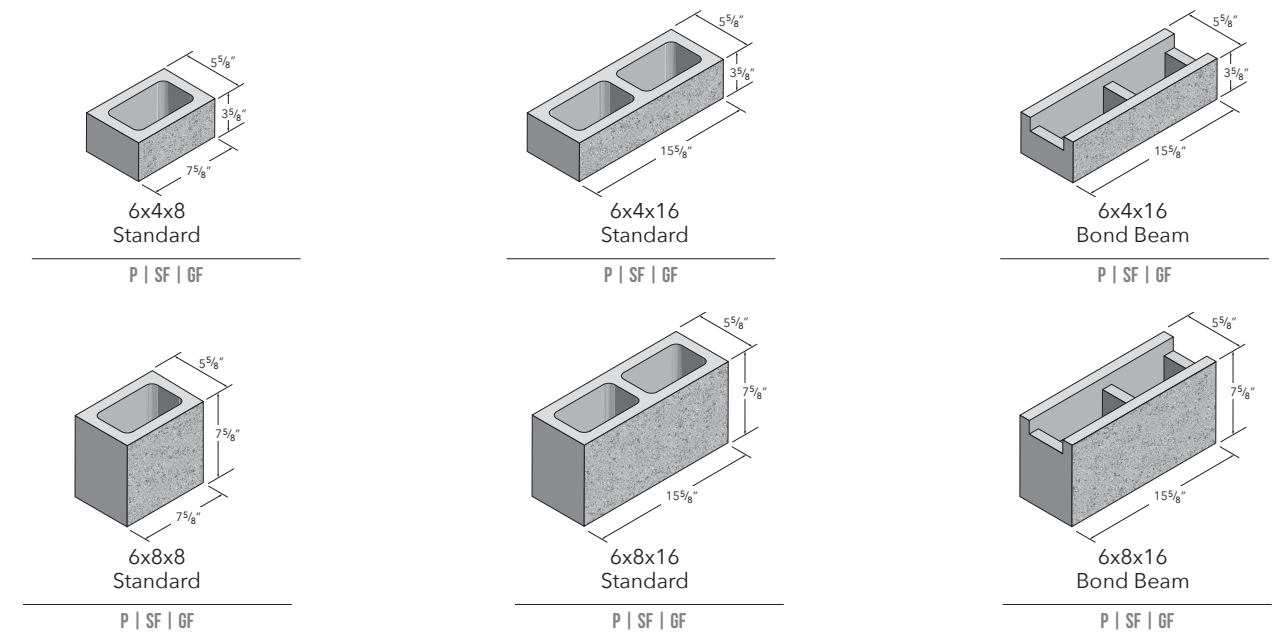

P | Precision SF | Split Face GF | Ground Face



# SHAPES | 8 INCH CMU

For texture availability please refer to the letter designation under each shape.

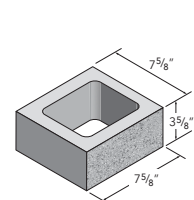

8x4x8  
Standard

P | SF | GF

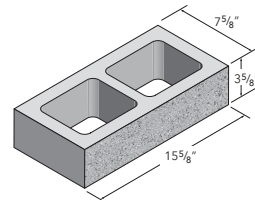

8x4x16  
Standard

P | SF | GF

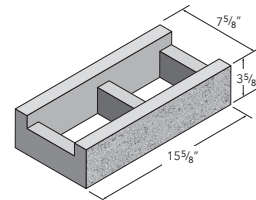

8x4x16  
Bond Beam

P | SF | GF

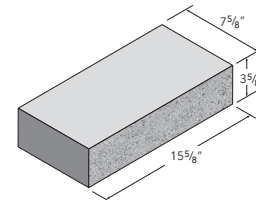

8x4x16  
Solid

P | SF | GF

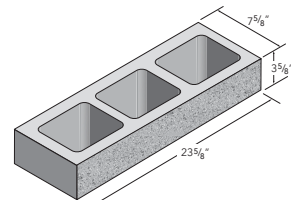

8x4x24  
Standard

P | SF | GF

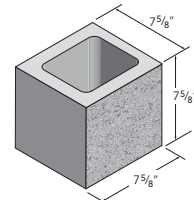

8x8x8  
Standard

P | SF | GF

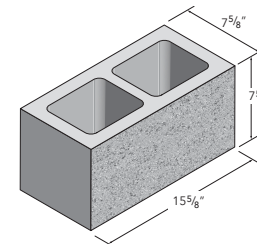

8x8x16  
Standard

P | SF | GF

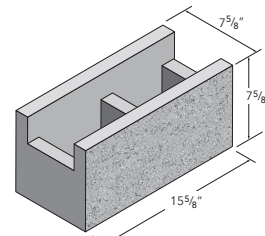

8x8x16  
Bond Beam

P | SF | GF

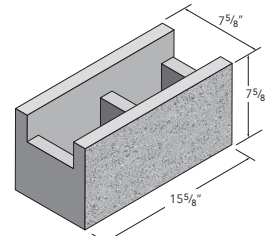

8x8x16  
Solid Bottom Bond Beam

P | SF | GF

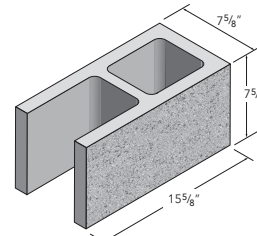

8x8x16  
SCOE Block

P | SF | GF

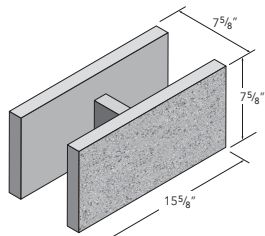

8x8x16  
DOE Block

P | SF | GF

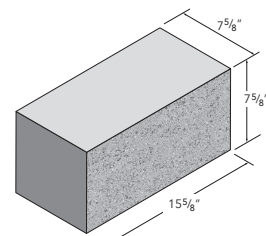

8x8x16  
Solid

P | SF | GF

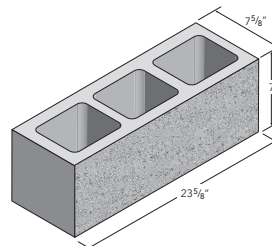

8x8x24  
Standard

P | SF | GF

P | Precision SF | Split Face GF | Ground Face

# SHAPES | 10 INCH CMU

For texture availability please refer to the letter designation under each shape.

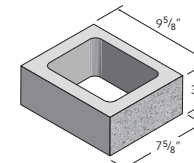

10x4x8  
Standard

P | SF | GF

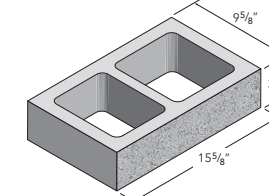

10x4x16  
Standard

P | SF | GF

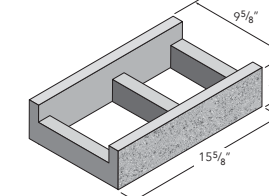

10x4x16  
Bond Beam

P | SF | GF

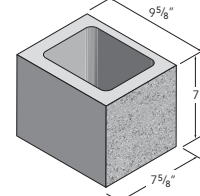

10x8x8  
Standard

P | SF | GF

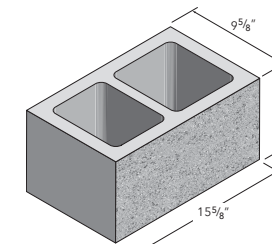

10x8x16  
Standard

P | SF | GF

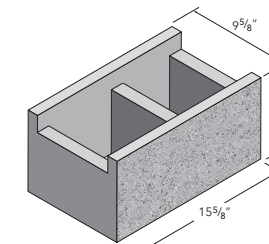

10x8x16  
Bond Beam

P | SF | GF

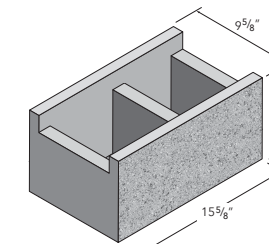

10x8x16  
Solid Bottom Bond Beam

P | GF

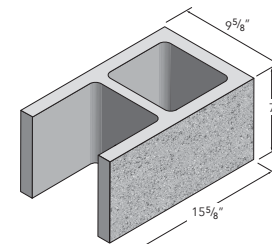

10x8x16  
SCOE Block

P | SF | GF

# SHAPES | 12 INCH CMU

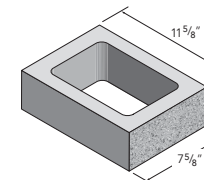

12x4x8  
Standard

P | SF | GF

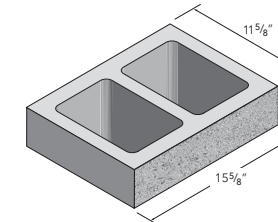

12x4x16  
Standard

P | SF | GF

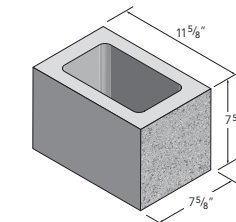

12x8x8  
Standard

P | SF | GF

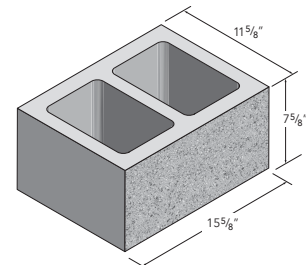

12x8x16  
Standard

P | SF | GF

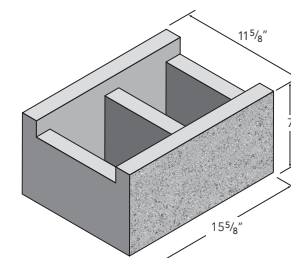

12x8x16  
Bond Beam

P | SF | GF

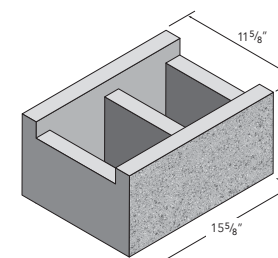

12x8x16  
Solid Bottom Bond Beam

P | GF

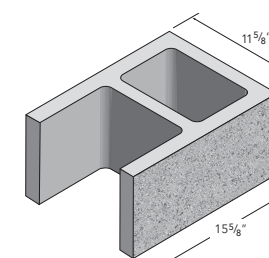

12x8x16  
SCOE Block

P | SF | GF

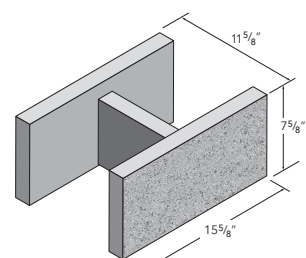

12x8x16  
DOE Block

P | SF | GF

P | Precision SF | Split Face GF | Ground Face



# SPECIALTY | CMU

For texture availability please refer to the letter designation under each shape.

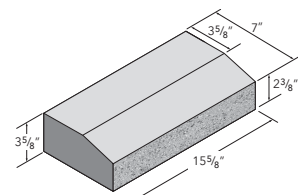

7x4x16  
Evolver Sill Solid

P | GF

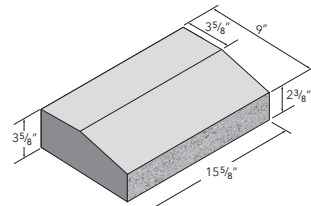

9x4x16  
Evolver Sill Solid

P | GF

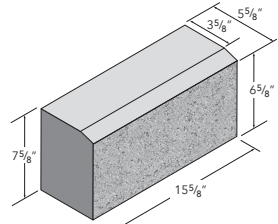

6x8x16  
Beveled Sill 2:1 Slope Solid

P | SF | GF

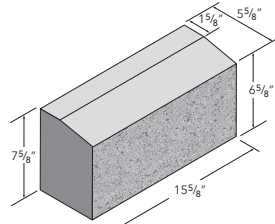

6x8x16  
Beveled Sill 4:1 Slope Solid

P | SF | GF

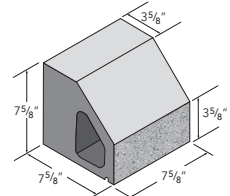

8x8x8  
Beveled Sill, Drip Groove, Cored

P | GF

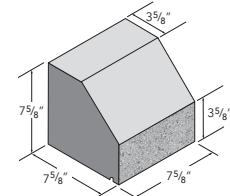

8x8x8  
Beveled Sill, Drip Groove, Solid

P | GF

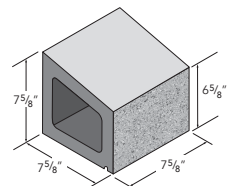

8x8x8  
Sloped Sill, Drip Groove, Cored

P | GF

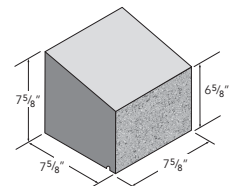

8x8x8  
Sloped Sill, Drip Groove, Solid

P | GF

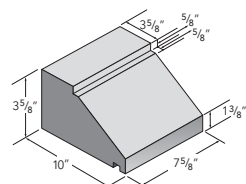

8x4x10  
Square Sill, Drip Groove, Solid

P

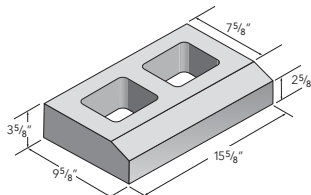

10x4x16  
Beveled Sill, 2:1 Slope, Cored

P

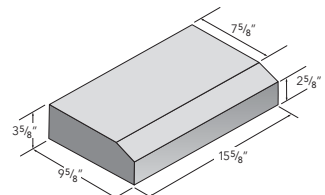

10x4x16  
Beveled Sill, 2:1 Slope, Solid

P

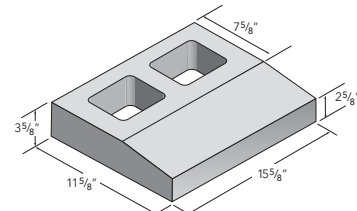

12x4x16  
Beveled Sill, 4:1 Slope, Cored

P

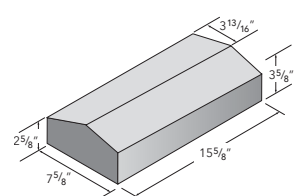

8x4x16  
Peak Cap

P

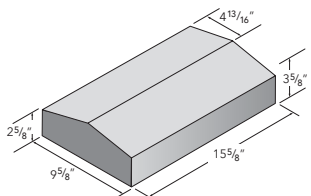

10x4x16  
Peak Cap

P

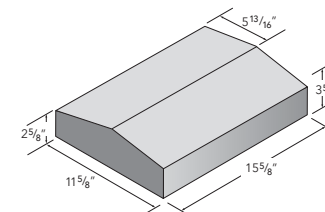

12x4x16  
Peak Cap

P | GF

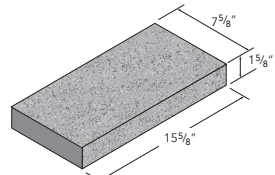

8x2x16  
Cap

P | GF

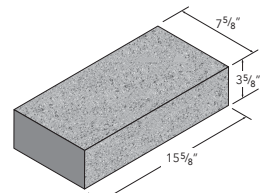

8x4x16  
Cap

P | GF

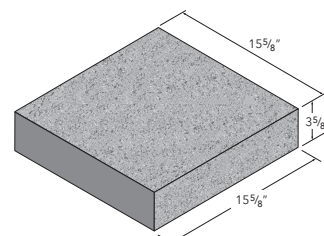

16x4x16  
Cap

P | GF

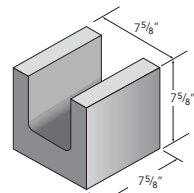

8x8x8  
Lintel

P | GF

P | Precision

GF | Ground Face

# SPECIALTY | INSULATION



## ADDED THERMAL PERFORMANCE

Korfil® inserts are individually molded from EPS and are designed to create a wall system capable of achieving higher thermal R values than conventional concrete masonry. Not sure which thermal wall system is right for your project? Call 253-964-5000 for more information.

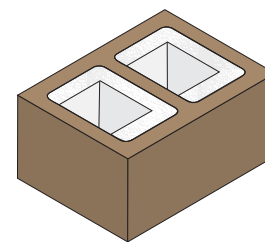
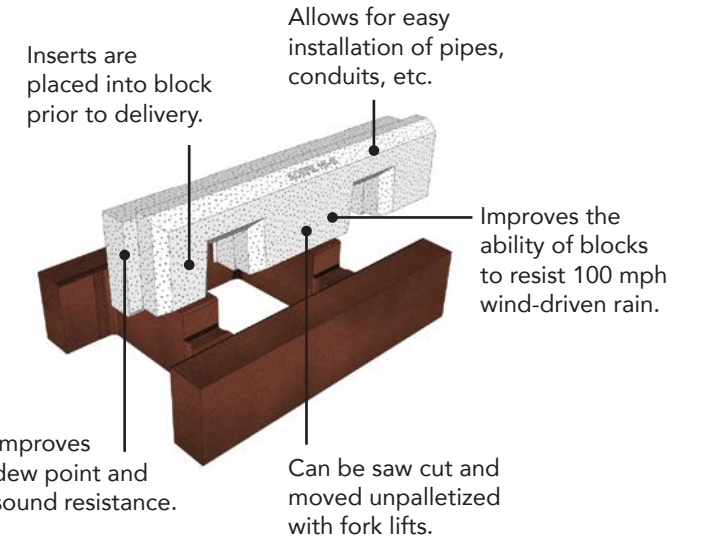

Korfil®

Fits Basalite's 2-core CMU of 6", 8", 10" and 12" widths for use in both single wythe and cavity wall construction.

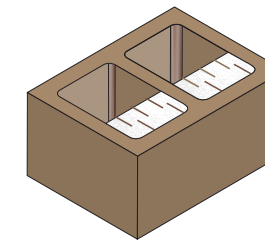

ICON®

Fits Basalite's 2-core CMU. Inserts compress to fit the cores of all masonry units with just one size.

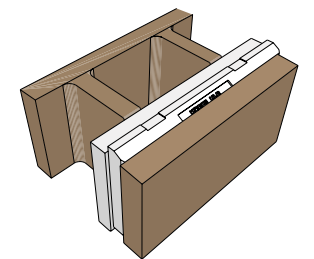

Korfil® Hi-R

Fits Basalite's 2 cross web CMU of 8", 10, or 12" widths. Suitable for fully or partially grouted walls.

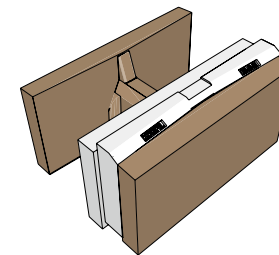

Korfil® Hi-R H

Fits Basalite's 1 cross web masonry units of 12" wide. Suitable for fully grouted walls.

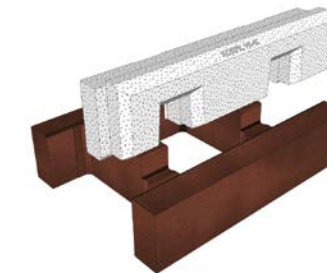

Spec-Brik® Hi-R

This Hi-R insert is designed to fit Spec-Brick units. Suitable for fully or partially grouted walls.

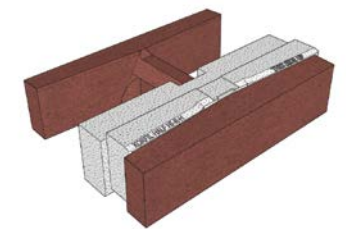

Spec-Brik® Hi-R H

This Hi-R H insulation insert is designed to fit Spec-Brick units. Suitable for fully grouted walls.





**SPECIALTY | SPEC-BRIK®**

For texture availability please refer to the letter designation under each shape.

# INCREASE THE SPEED OF CONSTRUCTION

Spec-Brik® is manufactured to job specifications and delivered quickly, making it ideal for projects requiring fast track construction. The product's smooth, brick-like texture is available in 12 standard colors and custom colors can be produced to your specifications. Visit [basalite-cmu.com/northwest-specbrik](http://basalite-cmu.com/northwest-specbrik) for color swatches or call 253-964-5000 for product samples.

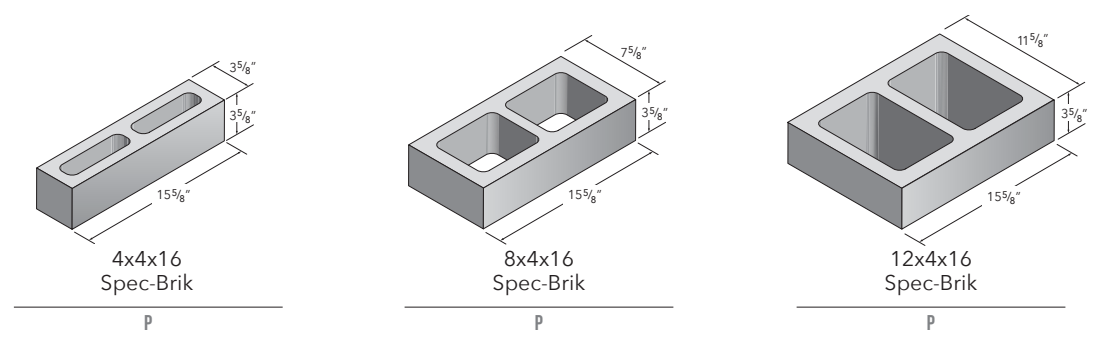

P | Precision



# COLORS & TEXTURES | GROUND FACE

**NEED MORE COLOR OPTIONS?**  
 Visit [basalite-cmu.com/northwest-all-textures-by-price](http://basalite-cmu.com/northwest-all-textures-by-price) or call 253-964-5000.

## STANDARD COLORS

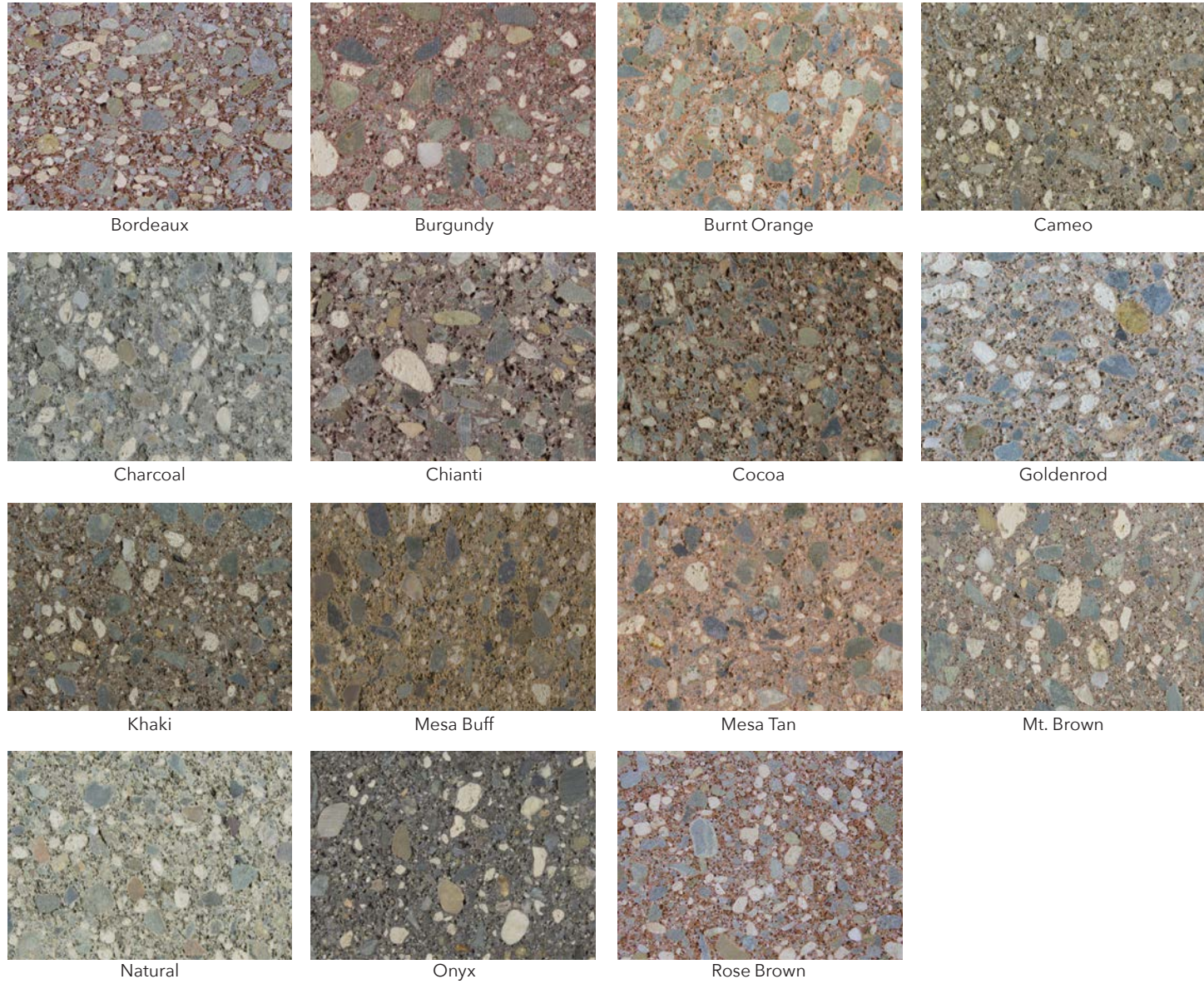

## PREMIUM COLORS

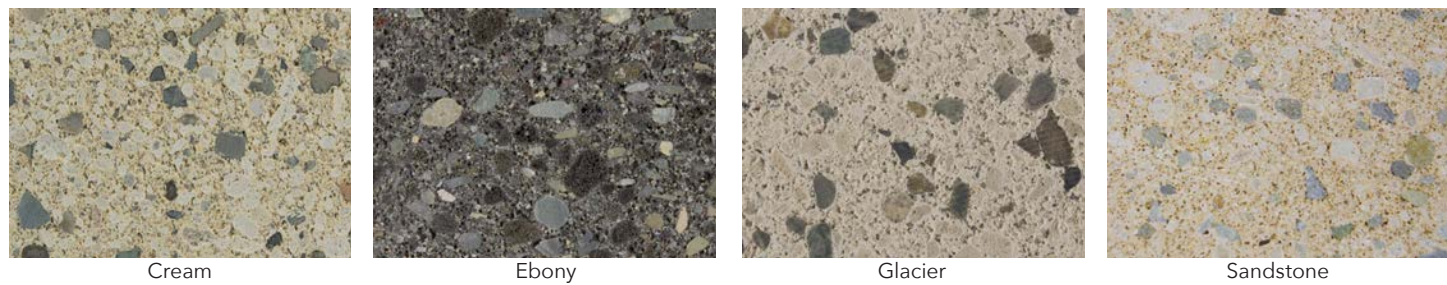

Printed colors shown in this brochure may vary from actual product colors. We recommend selecting colors from actual product samples.

# COLORS & TEXTURES | SPLIT FACE

**NEED MORE COLOR OPTIONS?**  
 Visit [basalite-cmu.com/northwest-all-textures-by-price](http://basalite-cmu.com/northwest-all-textures-by-price) or call 253-964-5000.

## STANDARD COLORS

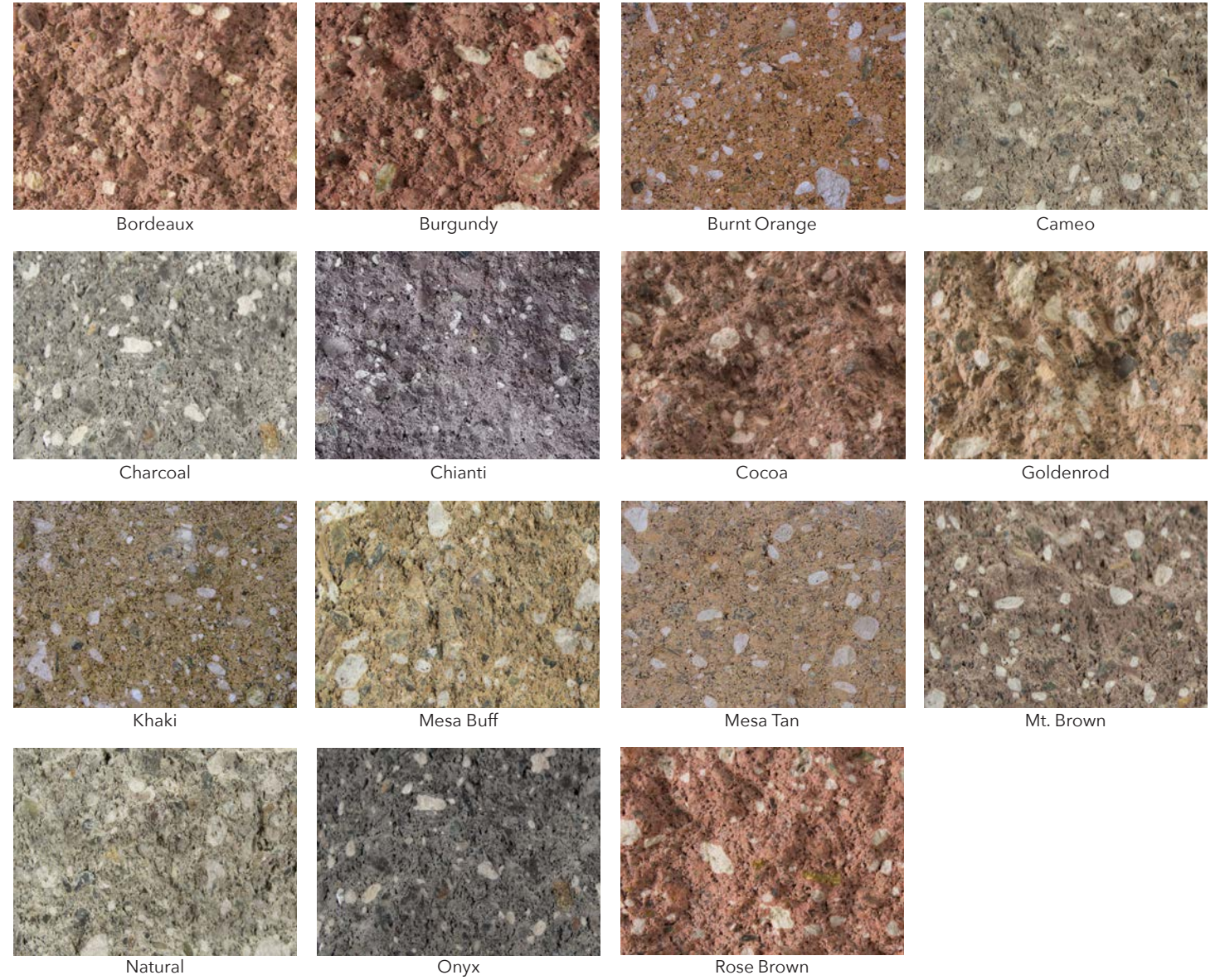

## PREMIUM COLORS



Printed colors shown in this brochure may vary from actual product colors. We recommend selecting colors from actual product samples.



# COLORS & TEXTURES | PRECISION

**NEED MORE COLOR OPTIONS?**  
 Visit [basalite-cmu.com/northwest-all-textures-by-price](http://basalite-cmu.com/northwest-all-textures-by-price) or call 253-964-5000.

## STANDARD COLORS



## PREMIUM COLORS



Printed colors shown in this brochure may vary from actual product colors. We recommend selecting colors from actual product samples.

# COLORS | MORTAR

**NEED PRODUCT SAMPLES?**  
 Email [dupontsales@basalite.com](mailto:dupontsales@basalite.com) or call 253-964-5000 to get your samples.

## STANDARD COLORS



## PREMIUM COLORS



## ULTRA PREMIUM COLORS

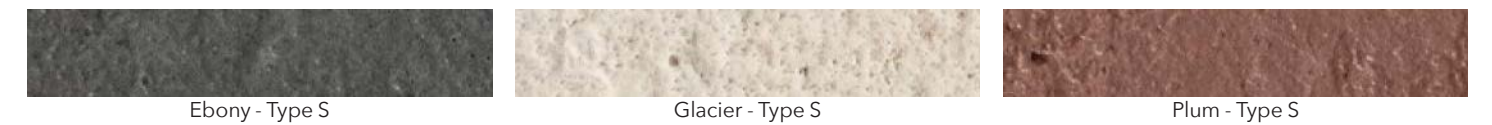

Printed colors shown in this brochure may vary from actual product colors. We recommend selecting colors from actual product samples.